

LOCATION PLAN  
Scale: 1:500

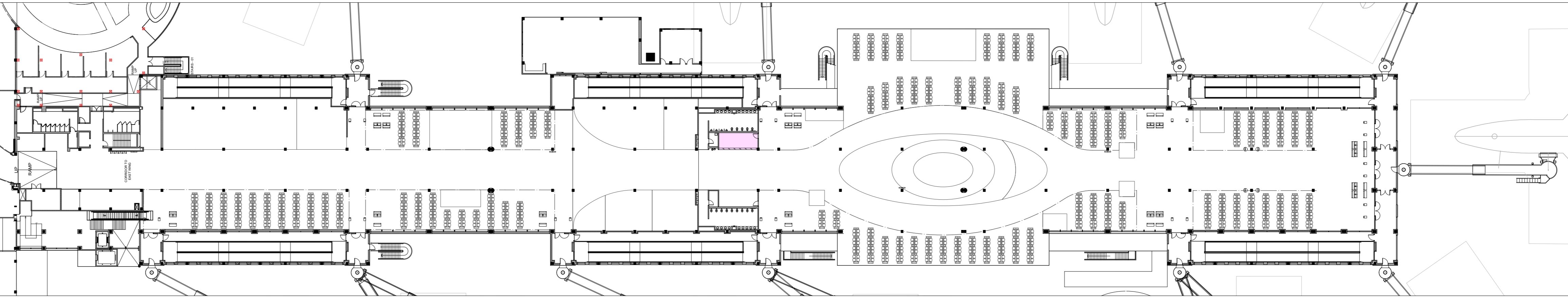

**DRAWINGS ARE INDICATIVE AND ALL DIMENSIONS NEED TO BE VERIFIED ON SITE**

**GENERAL NOTES:**

1. ALL DIMENSIONS AND DESIGN DETAILS MUST BE CONFIRMED AND VERIFIED WITH THE LOCAL ARCHITECT, INCLUDING STRUCTURAL AND M&E REQUIREMENTS
2. FLOORING BY CONCESSIONAIRE
3. LICENSOR DIVIDING WALLS - 150mm PLASTERBOARD PARTITION ON M-C STUDS (TBC BY LOCAL ARCHITECT) - INTERNAL FINISHES BY CONCESSIONAIRE
4. LIGHTING OVER RETAIL AREA TO BE PROVIDED BY CONCESSIONAIRE
5. ALL CONCESSIONAIRE FIXTURES AND FURNITURE TO BE SELF SUPPORTED, WITH LOAD BEING TAKEN THROUGH THE FLOOR

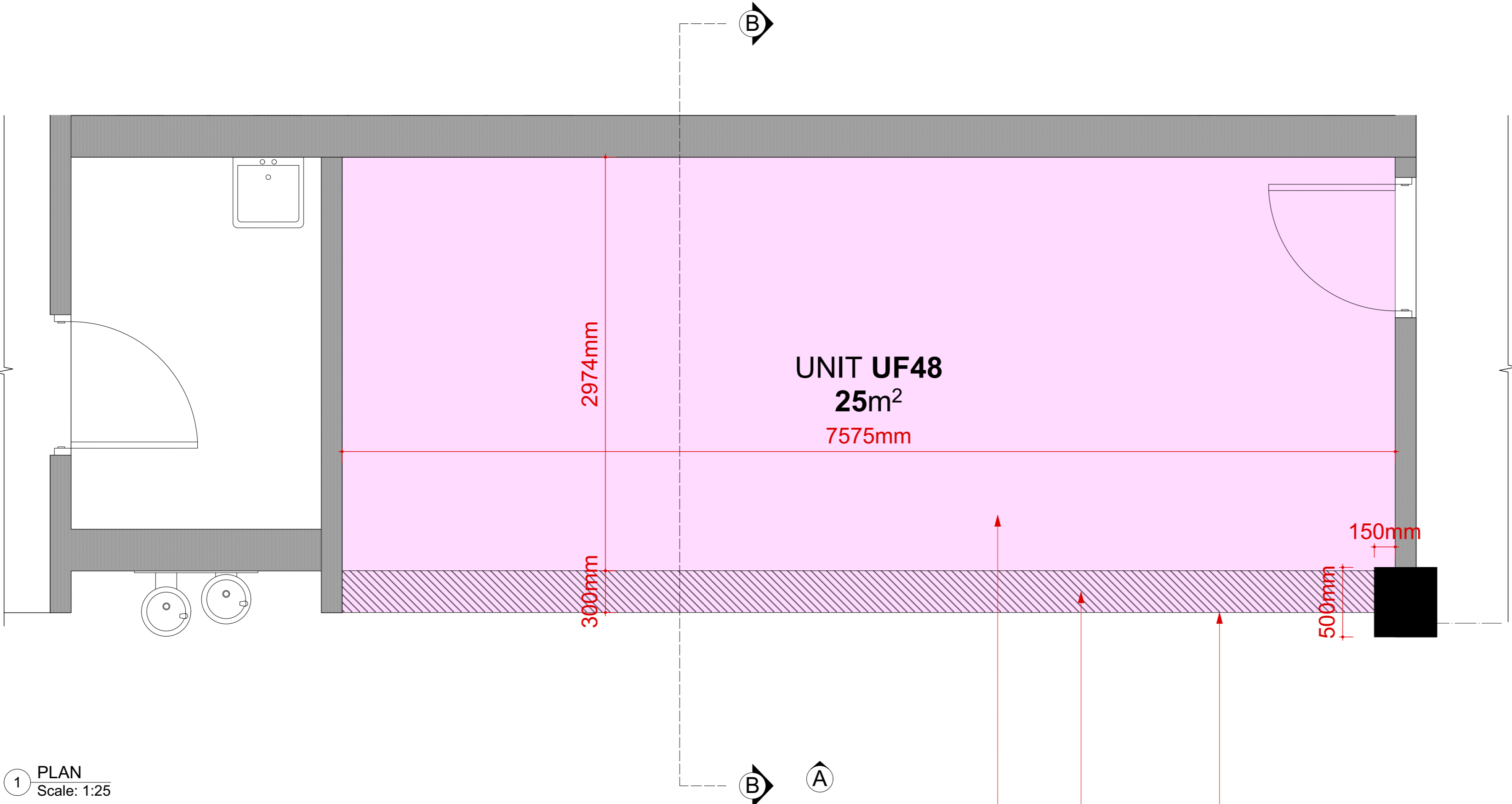

1 PLAN  
Scale: 1:25

RETAIL UNIT DEMISE LINE  
FURNITURE FREE ZONE  
FLOORING BY CONCESSIONAIRE



2 ELEVATION A  
Scale: 1:25

INDICATIVE HEIGHT -  
DEPENDANT ON SITE  
CONDITIONS- TBC WITH LOCAL  
ARCHITECT

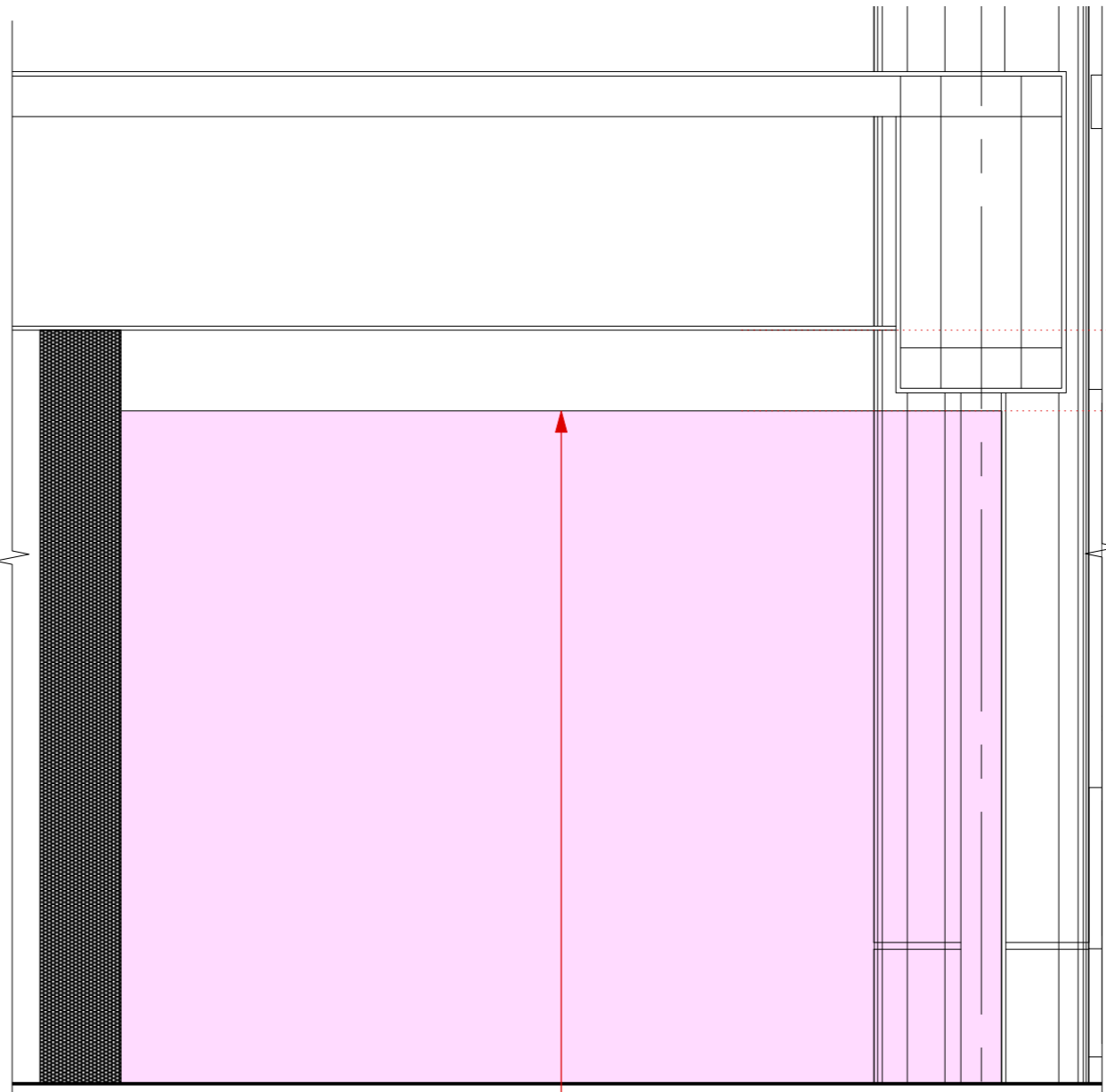

3 SECTION BB  
Scale: 1:25

INDICATIVE HEIGHT -  
DEPENDANT ON  
SITE CONDITIONS- TBC WITH LOCAL  
ARCHITECT

Rev	Desc	Author	Checker
1	Issue for tender	JM	JD
2	Issue for construction	JM	JD
3	Issue for construction	JM	JD
4	Issue for construction	JM	JD
5	Issue for construction	JM	JD
6	Issue for construction	JM	JD
7	Issue for construction	JM	JD
8	Issue for construction	JM	JD
9	Issue for construction	JM	JD
10	Issue for construction	JM	JD
11	Issue for construction	JM	JD
12	Issue for construction	JM	JD
13	Issue for construction	JM	JD
14	Issue for construction	JM	JD
15	Issue for construction	JM	JD
16	Issue for construction	JM	JD
17	Issue for construction	JM	JD
18	Issue for construction	JM	JD
19	Issue for construction	JM	JD
20	Issue for construction	JM	JD
21	Issue for construction	JM	JD
22	Issue for construction	JM	JD
23	Issue for construction	JM	JD
24	Issue for construction	JM	JD
25	Issue for construction	JM	JD
26	Issue for construction	JM	JD
27	Issue for construction	JM	JD
28	Issue for construction	JM	JD
29	Issue for construction	JM	JD
30	Issue for construction	JM	JD
31	Issue for construction	JM	JD
32	Issue for construction	JM	JD
33	Issue for construction	JM	JD
34	Issue for construction	JM	JD
35	Issue for construction	JM	JD
36	Issue for construction	JM	JD
37	Issue for construction	JM	JD
38	Issue for construction	JM	JD
39	Issue for construction	JM	JD
40	Issue for construction	JM	JD
41	Issue for construction	JM	JD
42	Issue for construction	JM	JD
43	Issue for construction	JM	JD
44	Issue for construction	JM	JD
45	Issue for construction	JM	JD
46	Issue for construction	JM	JD
47	Issue for construction	JM	JD
48	Issue for construction	JM	JD
49	Issue for construction	JM	JD
50	Issue for construction	JM	JD
51	Issue for construction	JM	JD
52	Issue for construction	JM	JD
53	Issue for construction	JM	JD
54	Issue for construction	JM	JD
55	Issue for construction	JM	JD
56	Issue for construction	JM	JD
57	Issue for construction	JM	JD
58	Issue for construction	JM	JD
59	Issue for construction	JM	JD
60	Issue for construction	JM	JD
61	Issue for construction	JM	JD
62	Issue for construction	JM	JD
63	Issue for construction	JM	JD
64	Issue for construction	JM	JD
65	Issue for construction	JM	JD
66	Issue for construction	JM	JD
67	Issue for construction	JM	JD
68	Issue for construction	JM	JD
69	Issue for construction	JM	JD
70	Issue for construction	JM	JD
71	Issue for construction	JM	JD
72	Issue for construction	JM	JD
73	Issue for construction	JM	JD
74	Issue for construction	JM	JD
75	Issue for construction	JM	JD
76	Issue for construction	JM	JD
77	Issue for construction	JM	JD
78	Issue for construction	JM	JD
79	Issue for construction	JM	JD
80	Issue for construction	JM	JD
81	Issue for construction	JM	JD
82	Issue for construction	JM	JD
83	Issue for construction	JM	JD
84	Issue for construction	JM	JD
85	Issue for construction	JM	JD
86	Issue for construction	JM	JD
87	Issue for construction	JM	JD
88	Issue for construction	JM	JD
89	Issue for construction	JM	JD
90	Issue for construction	JM	JD
91	Issue for construction	JM	JD
92	Issue for construction	JM	JD
93	Issue for construction	JM	JD
94	Issue for construction	JM	JD
95	Issue for construction	JM	JD
96	Issue for construction	JM	JD
97	Issue for construction	JM	JD
98	Issue for construction	JM	JD
99	Issue for construction	JM	JD
100	Issue for construction	JM	JD

the  
Design  
Solution

100 King Street, Suite 100  
Montego Bay, Jamaica  
Tel: +1 876 525 1111  
www.thedesignsolution.com

SANISTER INTERNATIONAL AIRPORT  
MONTGO BAY  
JAMAICA

UNIT - UF48

PRELIMINARY

Rev	Rev	Rev	Rev
1	2	3	4
1:25 @ A0	1:25 @ A0	1:25 @ A0	1:25 @ A0
2017	2017	2017	2017
2786	2786	2786	2786
MBU	MBU	MBU	MBU
2-105	2-105	2-105	2-105
UF48	UF48	UF48	UF48